

**STRATFORD GEODUCK FARM ACTIVITY LOG**  
**Permit Number SD55-05**

<b>Activity</b>	<b>Date</b>	<b>Time</b>	<b>Details</b>
Boundary Survey Completed	6/22/09		Property staked
Eel Grass Survey	6/22/09	≈11:00	Site plan attached
Buoys Anchored	7/20/09		Property corners marked "Taylor Shellfish" (4 buoys)
Tube Installation	7/20/09-7/25/09	Low Tide	24,023 tubes marked with "taylorshellfish.com"
Geoduck Seed Planting	7/20/09-7/25/09	Low Tide	36,132 seed
Net Installation	7/20/09-7/25/09	Low Tide	8 tags per net marked with name, address, phone number
Site Inspection	9/22/09	2:00 AM	No tubes found unsecured on-site or on adjacent properties; one net corner re-staked
Site Inspection	10/7/09	2:00 AM	No problems
Site Inspection	11/3/09	11:00PM	No problems

Site Inspection	12/6/09	2:00AM	<p>Notice was given to Pierce County. 12/8/09. The notice stated in part:</p> <p>On December 6, Taylor Shellfish had a crew patrolling the beaches south and north of our Stratford-Meyer geoduck farm (SD55-05 and SD53-05) as required by Condition 8 of our shoreline permit. That conditions reads, "Area beaches within ½ mile on either side of the project site shall be patrolled by the applicant every other week to retrieve debris that escapes from the farm."</p> <p>Strong winds and rough waters dislodged some tubes that the crew was retrieving north of the farm. The homeowner approached and threatened the crew with a gun and told them to leave. Our crew left. It is not possible for us to retrieve debris that may have landed on that homeowner's property, nor will we attempt to access that property again.</p>
Site Inspection	1/3/10	12:30AM	Repair nets and picked up tubes
Site Inspection	1/11/10	9:30 PM	Repair nets and picked up tubes
Site Inspection	2/25/10	12:30AM	Inspected nets and picked up tubes
Site Inspection	3/4/10	12:00PM	Inspected nets, follow-up on phone call (2/22/10)
Beach Clean Up	3/11/10	7:00AM	Bi-Annual Beach Clean Up

Site Inspection	3/31/10		Follow up from Lessor phone call-tube pick up
Site Inspection	4/17/10	1:30PM	Follow up from Lessor phone call-tube pick up
Site Inspection	4/30/10		Follow up from phone call from neighbor
Site Inspection	5/2/10		Checked farm
Site Inspection	5/10/10		Follow up from phone call from neighbor to pick up tubes
Site Inspection	5/17/10		Follow up from email complaint about tubes at Vaughn Bay

**MEYER GEODUCK FARM ACTIVITY LOG**  
**Permit Number SD53-05**

<b>Activity</b>	<b>Date</b>	<b>Time</b>	<b>Details</b>
Boundary Survey Completed	6/22/09		Property staked
Eel Grass Survey	6/22/09	≈11:00	Site plan attached
Buoys Anchored	7/20/09		Property corners marked "Taylor Shellfish" (4)
Tube Installation	7/20/09-7/25/09	Low Tide	13,788 tubes marked with "taylorshellfish.com"
Geoduck Seed Planting	7/20/09-7/25/09	Low Tide	18,393 seed
Net Installation	7/20/09-7/25/09	Low Tide	8 tags per net marked with name, address, phone number
Site Inspection	9/22/09	2:00AM	No tubes found unsecured on-site or on adjacent properties; one net corner re-staked
Site Inspection	10/7/09	2:00AM	No problems
Site Inspection	11/3/09	11:00PM	No problems

Site Inspection	12/6/09	2:00AM	<p>Notice was given to Pierce County. 12/8/09. The notice stated in part:</p> <p>On December 6, Taylor Shellfish had a crew patrolling the beaches south and north of our Stratford-Meyer geoduck farm (SD55-05 and SD53-05) as required by Condition 8 of our shoreline permit. That conditions reads, "Area beaches within ½ mile on either side of the project site shall be patrolled by the applicant every other week to retrieve debris that escapes from the farm."</p> <p>Strong winds and rough waters dislodged some tubes that the crew was retrieving north of the farm. The homeowner approached and threatened the crew with a gun and told them to leave. Our crew left. It is not possible for us to retrieve debris that may have landed on that homeowner's property, nor will we attempt to access that property again.</p>
Site Inspection	1/3/10	12:30AM	Repair nets and picked up tubes
Site Inspection	1/11/10	9:30 PM	Repair nets and picked up tubes
Site Inspection	2/25/10	12:30AM	Inspected nets and picked up tubes
Site Inspection	3/4/10	12:00PM	Inspected nets, follow-up on phone call (2/22/10)
Beach Clean Up	3/11/10	7:00AM	Bi-Annual Beach Clean Up

Site Inspection	3/31/10		Follow up from Lessor phone call-tube pick up
Site Inspection	4/17/10	1:30PM	Follow up from Lessor phone call-tube pick up
Site Inspection	4/30/10		Follow up from phone call from neighbor
Site Inspection	5/2/10		Checked farm
Site Inspection	5/10/10		Follow up from phone call from neighbor to pick up tubes
Site Inspection	5/17/10		Follow up from email complaint about tubes at Vaughn Bay

NW's - 2007-1210  
Taylor Shellfish  
June 13, 2007

KEY PENINSULA

CASE INLET

GEODUCK PLANTING AREA  
INDIVIDUAL GEODUCK PLANTING

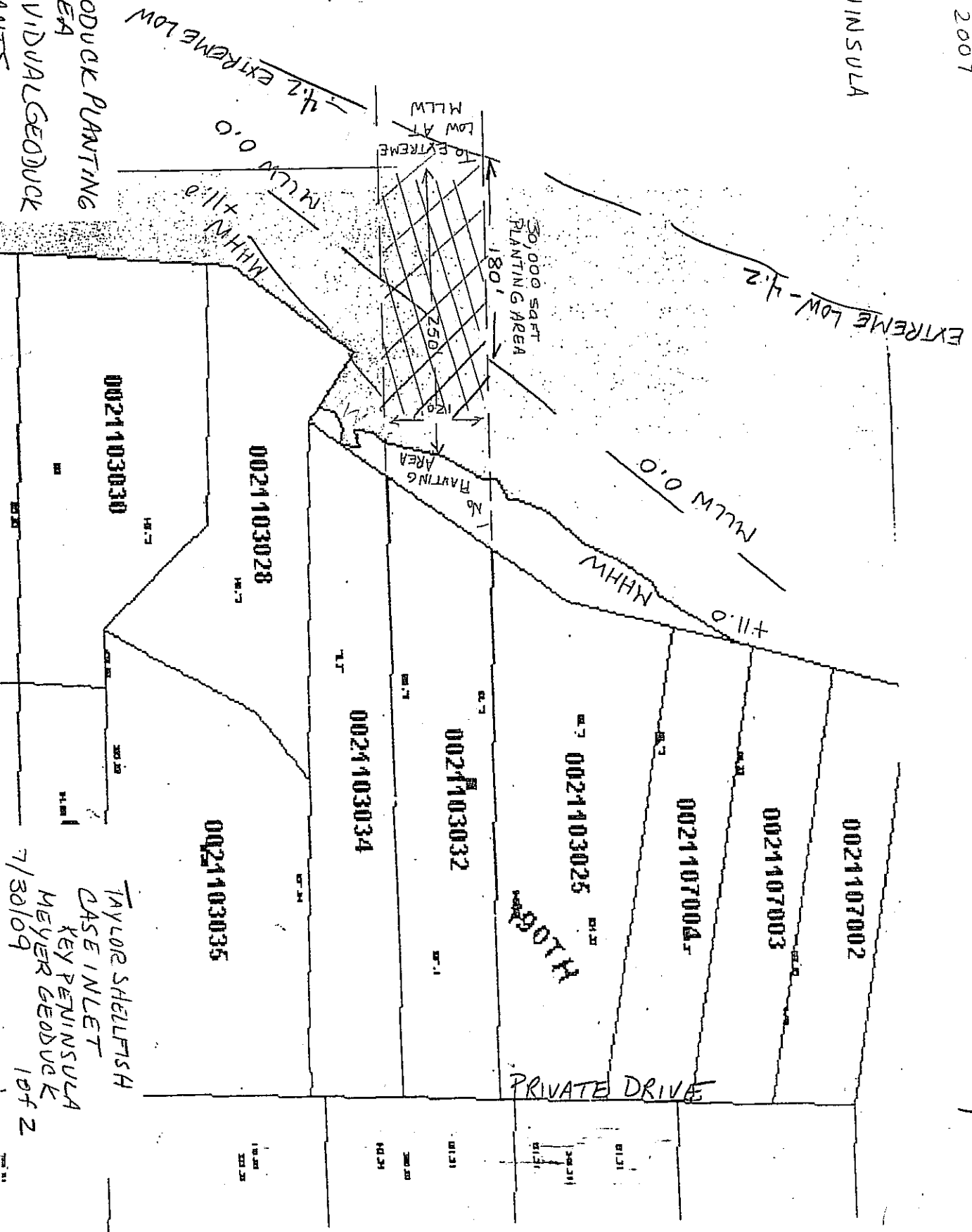

TAYLOR SHELLFISH  
CASE INLET  
KEY PENINSULA  
MEYER GEODUCK  
7/30/09 1042

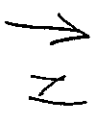

NWS-2007-1205  
Taylor Shellfish

KEY PENINSULA

CASE INLET

EXTREME LOW -4.2

EXTREME LOW -4.2

AT MLLW  
TO EXTREME LOW

GEODUCK PLANTING  
AREA  
WV BELGRASS  
INDIVIDUAL GEODUCK  
PLANTING

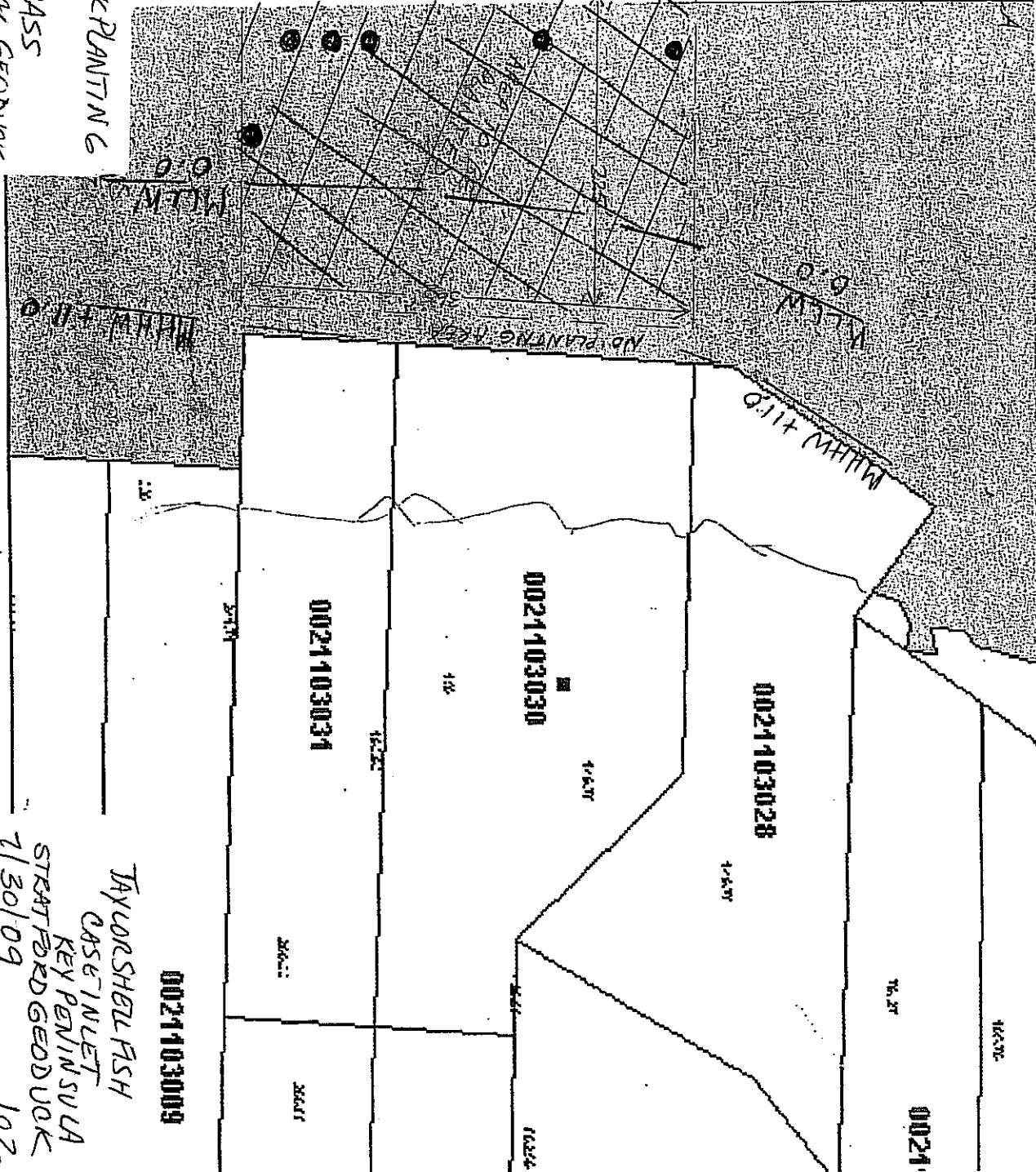

PRIVATE DRIVE

TAYLOR SHELLFISH  
CASE INLET  
KEY PENINSULA  
STRATFORD GEODUCK  
7/30/09  
102